



## ÒÛÚÛŠĜĤĖÖŦ Ğ€

Power supply units and control gears

## Technical Specs

### ECPNL2301DM20 Touch Panel

Input Voltage:	115-230 Vac 50/60 Hz
Output Signal:	RF 2.4GHz,
Control Mode:	DMX512 RGBW, 4 Zones Control
Working Temp.:	-30°C~ 55°C
Size:	L86×W86×H36 (mm)
Weight(G.W.):	225 g

## TOUCH PANEL (RGBW)

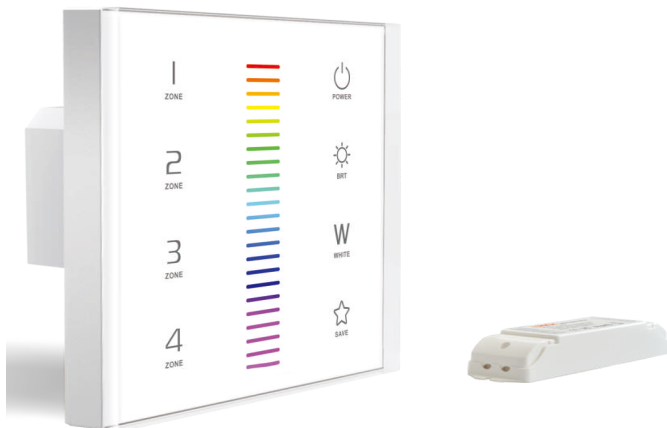

Product Size:

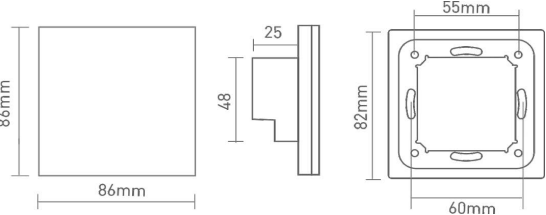

Terminals

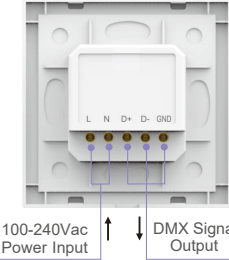

## Installation Instruction:

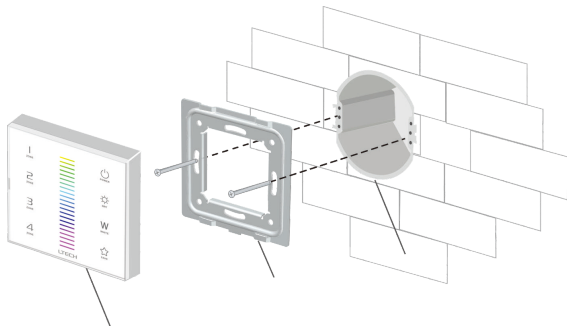

1. Install the back box into the wall. Typical boxes as below:

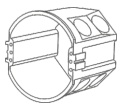

European style

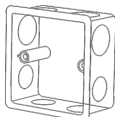

86 size

2. screw the baseplate and the back box in the wall firmly.

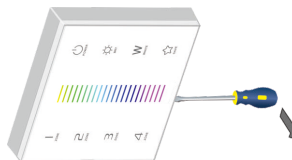

3. Connect in a right way and put the panel into the back box.

4. Use a straight screwdriver to pry the position shown:

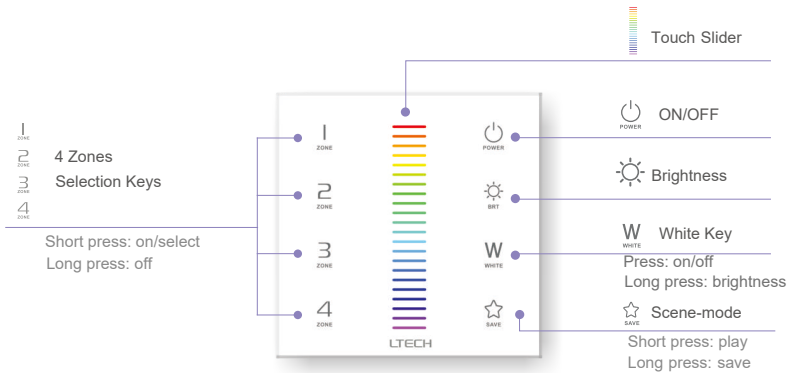

# Key Functions



- \* When the touch panel is off, Long press to  turn on/off the buzzer
- When the touch panel is on, Long press  to match code.

## Wireless System Wiring

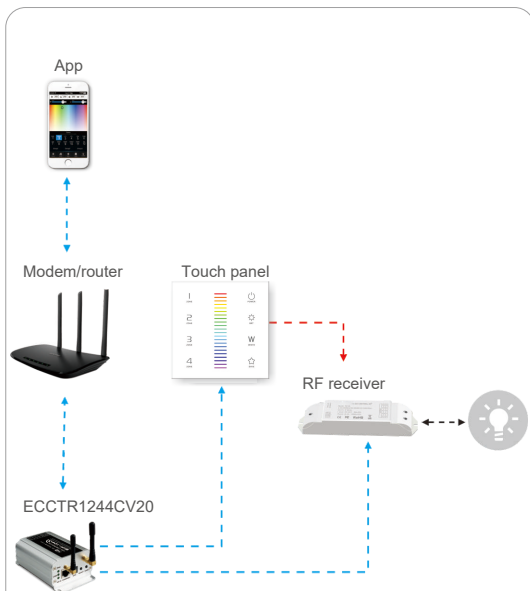

\*PS: No WiFi router needed when ECCTR1244CV20 work with phones directly.

### Match Code Sequence

1. ECCTR1244CV20 & ECPNL2301DM20
2. ECPNL2301DM20 & RF receiver

## Match / Clear Code for Touch panel & ECCTR1244CV20

Match Code:

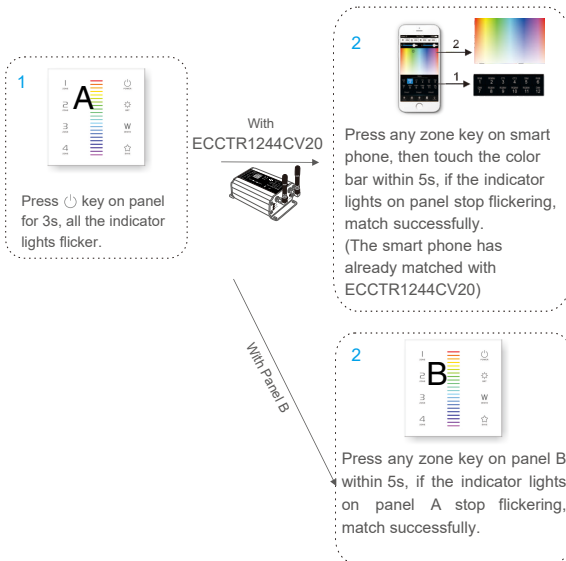

Clear Code:



## Application Composition

Wireless Control options:



## DMX Output Wiring

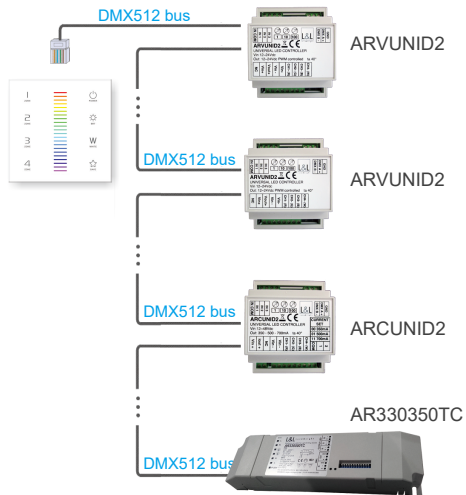

## RF Wireless Wiring

### Match/Clear Code between Touch Panel & Receiver

#### Match code:

Method 1 : When the touch panel is on and the wiring between the receiver and the lamps are correct.

1.



Power on the receiver, and complete step 2 within 10s.

2.

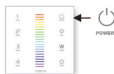

Long press  on the touch panel, the lamps flicker.

3.

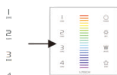

Touch the matching zone key on the touch panel, the lamps stop flickering, match successfully.

Method 2 : When the touch panel is on and the wiring between the receiver and the lamps are correct.

1.



Short press "ID learning button" on the receiver.

2.

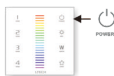

Long press  on the touch panel, the lamps flicker.

3.

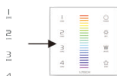

Touch the matching zone key on the touch panel, the lamps stop flickering, match successfully.

#### Clear code:

Method 1: Power on and off the receiver continuously for 5 times, if the buzzer long beep and lamps flicker twice, deactivate the matching successfully.



Method 2: Long press "ID learning button" on receiver for 5 seconds, if the lamps flicker twice, deactivate the matching successfully.

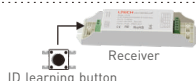



## ECPNL2301DM20

Alimentatori ed elettronica di controllo

## Specifiche tecniche

### ECPNL2301DM20 Touch Panel

Alimentazione:	115-230 Vac 50/60 Hz
Output R.F.:	RF 2.4GHz,
Controllo:	DMX512 RGBW, 4 Zone
Temperatura utilizzo:	-30°C ~ 55°C
Dimensioni:	L86×W86×H36 (mm)
Peso:	225 g

## TOUCH PANEL (RGBW)

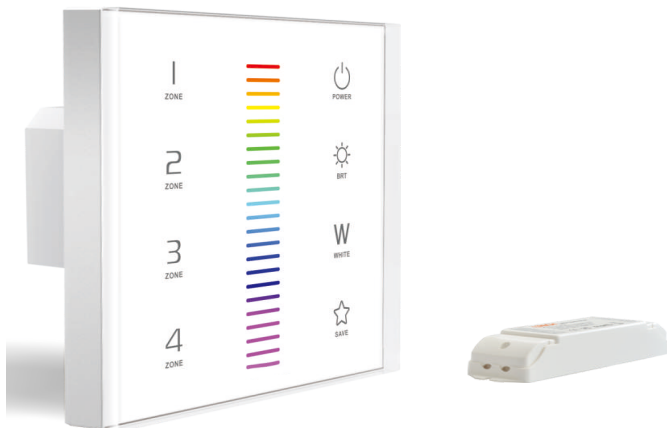

## Dimensioni:

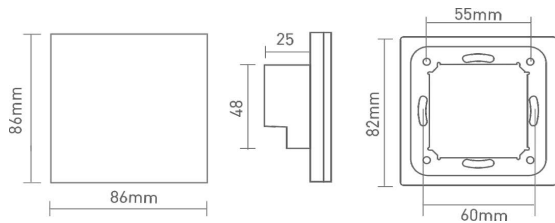

## Connessioni

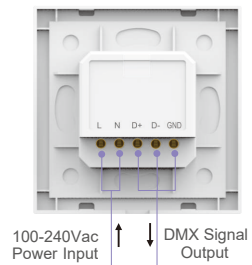

## Istruzioni di installazione:

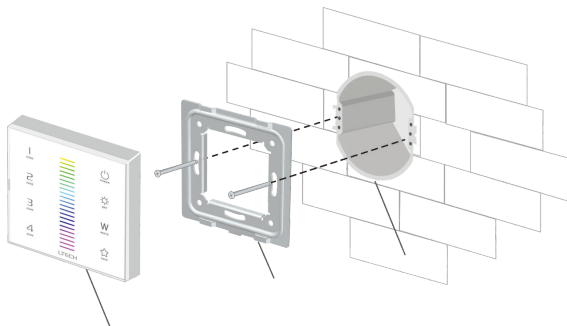

1. Installare la scatola di connessione nel muro. Tipo di scatole adatte:

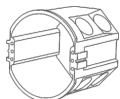

Europa style

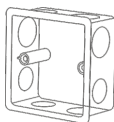

86x86

2. Avvitare saldamente la piastra di base e la scatola posteriore nel muro.

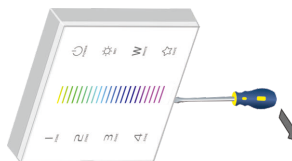

3. Eseguire i collegamenti in maniera corretta e posizionare il pannello nella scatola.

4. Utilizzare un cacciavite piatto per fare leva nella posizione mostrata:



## Funzionalita'



- \* Quando il pannello e' spento, pressione prolungata  per ON/Off del suono
- Quando il pannello e' acceso, pressione prolungata  per accoppiare il dispositivo.

## Connessioni Wireless

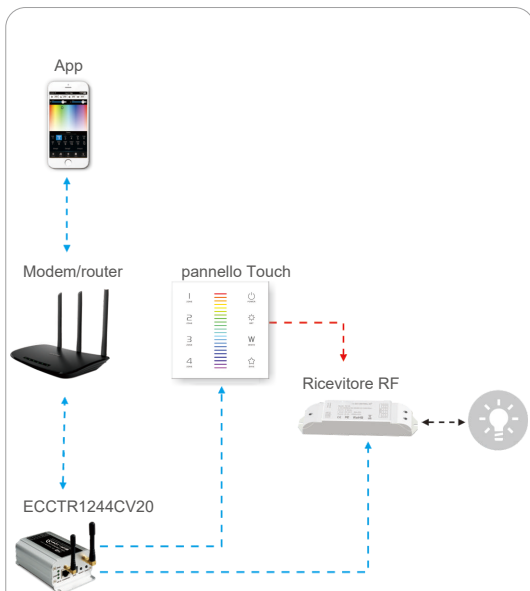

\*PS: WiFi router non necessario quando ECCTR1244CV20 si connette direttamente al telefono

### Sequenza per abbinamento prodotti

1. ECCTR1244CV20 & ECPNL2301DM20
2. ECPNL2301DM20 & ricevitore RF

## Accoppiamento/Cancelazione codici tra pannello touch e ECCTR1244CV20

Accoppiamento:

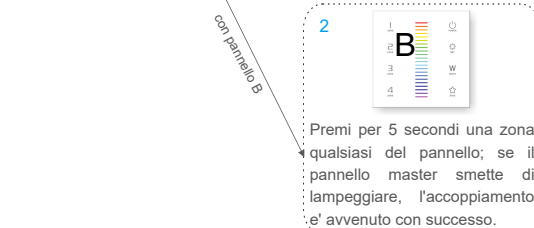

Cancelazione:

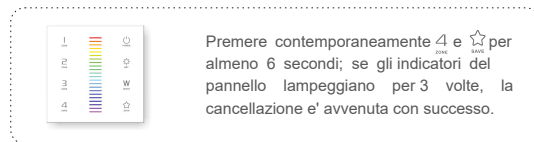

## Composizione

Opzioni di controllo wireless:

APP



cv 4 canali  
ECCTR1244CV20



cc 4 canali  
ECCTS1284CC20  
cv 4 canali  
ECCTS5244CV20



DMX512 output 1-4 zone  
ECCTS5241DM20

APP



cc 4 canali  
cv 4 canali

APP



DMX512 output  
1-4 zone

## Connessioni DMX

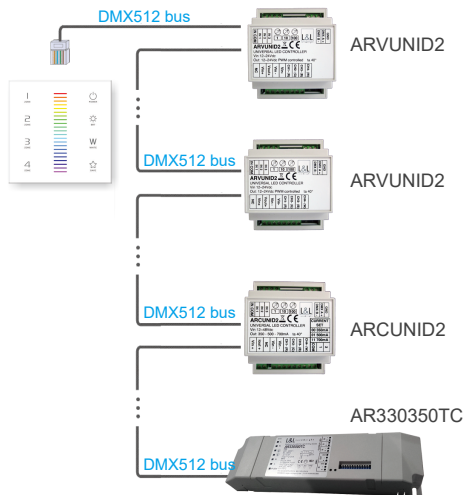

## Connessioni Radio Frequenza

### Accoppiamento/Cancellazione codici tra pannello touch e riceventi RF

#### Accoppiamento ricevente:

Metodo 1 : quando il pannello e' acceso e i collegamenti tra la ricevente e i farette sono corretti

1.



Alimentare la ricevente e completare il passo 2 entro 10 secondi

2.

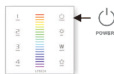

Pressione prolungata su il faretto lampeggia.

3.

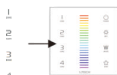

Tocca una delle icone relative alle zone; la lampada smette di lampeggiare. L'accoppiamento e' avvenuto con successo.

Metodo 2 : quando il pannello e' acceso e i collegamenti tra la ricevente e i farette sono corretti

1.



Pressione veloce del pulsante "ID learning button" sulla centralina

2.

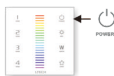

Premere a lungo sul pannello; il faretto lampeggia.

3.

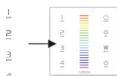

Tocca una delle icone relative alle zone; la lampada smette di lampeggiare. L'accoppiamento e' avvenuto con successo.

#### Cancellazione ricevente:

Metodo 1: accendere e spegnere la ricevente per 5 volte; si sente un lungo beep e la lampada lampeggia 2 volte; la cancellazione e' avvenuta.



Metodo 2: pressione prolungata per 5 secondi su "ID learning button"; se la lampada lampeggia due volte la cancellazione e' avvenuta.

