

Made in Italy



Spot 1.0 316L, code: PW10120SAI

Projectors for outdoor and underwater applications

13/09/2025 Rev. 09/2024

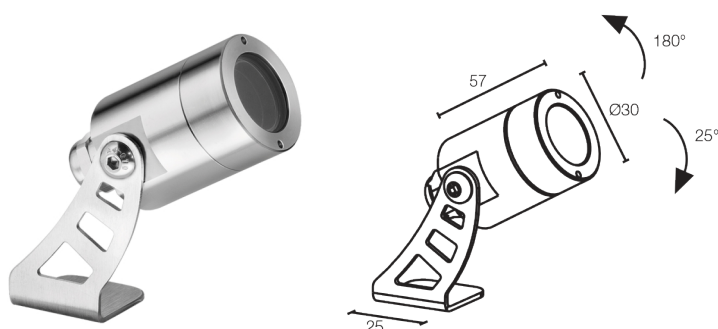
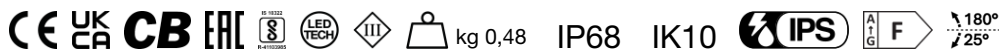

DESCRIPTION

projector for outdoor and underwater applications; surface mounted (ceiling, wall, ground, spike), max depth 10 m; Power consumption: max 2W; Power supply: max 500mA; Lumen output at source: 145 lm (3000K, 500mA); Delivered lumen output: 88 lm (3000K, 500mA, 20°); 1 power LED, 1/4 ANSI BIN, 50 000h L90 B10 (Ta 25°C); LED colour: 5000K; Optics: 10°; CRI Colour Rendering Index: 80; Body material: body and trim in AISI 316L stainless steel; Screen material: screen in tempered, transparent glass; power supply unit not included; Wiring: series; includes 5 m neoprene cable H05RN-F 2x0.35/0.75 Ø6.3 mm; Control system: dimming via dimmable driver; Ingress protection: IP68; Impact resistance: IK10; version with elliptical optics available on request; Casambi control using the Casambi app with dedicated electronics; Protection systems: IPS (Intelligent Protection System) protects lighting fixtures from water infiltrations, which can occur if there are faulty junctions between the cables in outdoor or underwater applications. This innovation, patented by L&L, also guarantees electrical protection against polarity reversal, hot plugging, ESD and power surges, which can occur if there are faults in the electrical circuit; Operating temperature: -20°C — +45°C (installation outdoors), 0°C — +45°C (installation underwater); Glow wire test: 960°C; Photobiological safety: photobiological safety: risk group 1 according to EN 62471:2006; Appliance class: class III; Weight: 480 g; Dimensions: Ø30x57mm; Energy efficiency class: F (light source) in accordance with EU 2019/2015; Accessories: WP0100 Spike for in-ground installation; tested and approved via E.O.L. (End Of Line) test with functioning test and check of electrical power consumption

Status: Available

ELECTRICAL CHARACTERISTICS

| | |
|-------------------|--------------------------------|
| Power consumption | max 2W |
| Power supply | max 500mA |
| Power supply unit | power supply unit not included |
| Control system | dimming via dimmable driver |
| Wiring | series |

LIGHTING CHARACTERISTICS

| | |
|----------------------------|---------------------------|
| Number and type of LED | 1 power LED |
| Average LED life | 50 000h L90 B10 (Ta 25°C) |
| LED colour | 5000K |
| CRI Colour Rendering Index | 80 |
| Binning | 1/4 ANSI BIN |
| Optics | 10° |
| Lumen output at source | 145 lm (3000K, 500mA) |
| Delivered lumen output | 88 lm (3000K, 500mA, 20°) |

MECHANICAL CHARACTERISTICS

| | |
|-----------------|--|
| Dimensions | Ø30x57mm |
| Weight | 480 g |
| Mounting | with bracket, screws and plugs |
| Body material | body and trim in AISI 316L stainless steel |
| Screen material | screen in transparent, tempered glass |

GENERAL CHARACTERISTICS

| | |
|-------------------------|---|
| Ingress protection | IP68 |
| Operating temperature | -20°C — +45°C (installation outdoors), 0°C — +45°C (installation underwater) |
| Impact resistance | IK10 |
| Energy efficiency class | F (light source) in accordance with EU 2019/2015 |
| Glow wire test | 960°C |
| Appliance class | class III |
| Walkover | no |
| Drive-over | no |
| Power cables | includes 5 m neoprene cable H05RN-F 2x0.35/0.75 Ø6.3 mm |
| Protection systems | IPS (Intelligent Protection System) |
| Photobiological safety | photobiological safety: risk group 1 according to EN 62471:2006 |
| Notes | version with elliptical optics available on request; Casambi control using the Casambi app with dedicated electronics |

PHOTOMETRIC DATA

S - 10°

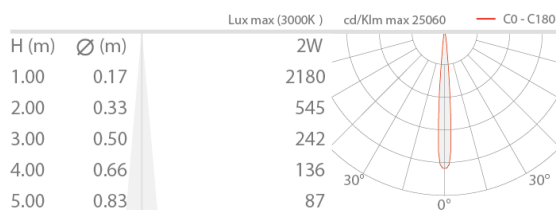

ACCESSORIES

Installation Accessories



WP0100

Spike for in-ground installation

L&L Luce&Light SRL reserves the right to change the information contained in this document at any time without prior notice being given.