



OUTDOOR AND UNDERWATER PROJECTORS FOUNTAINS AND HARSH ENVIRONMENTS



narrow medium wide



2700K 3000K 4000K 5000K blue

UNDERWATER

COVER
Ø30 mm

COVER
Ø69 mm

COVER
Ø124 mm

CONSTANT CURRENT



SPOT 1.0 316L p. 754
max 2W max 500mA



SPOT 2.0 316L p. 755
max 6W max 500mA

CONSTANT VOLTAGE



SPOT 1.6 316L p. 754
2W 24Vdc



SPOT 2.6 316L p. 755
6W 24Vdc

WHITE AND BLUE LIGHT:
CONSTANT VOLTAGE

RGB LIGHT:
CONSTANT CURRENT



SPOT 3.0 316L p. 757
12W/18W 24Vdc
RGB: max 18W max 500mA

OUTDOOR

SPOT p. 272

< SPOT 3.0 316L
3000K, 12W, 40°

Light planning by / ing. Paolo Saracino
and ing. Donato Saracino
Grotta Zinzulusa, Castro Marina, Lecce, Italy

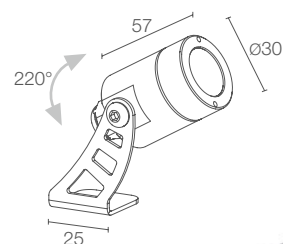
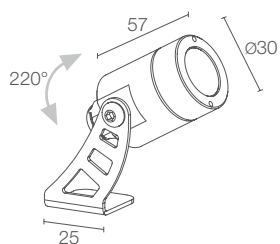
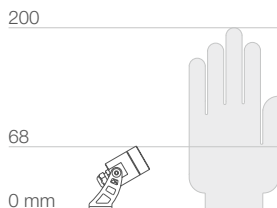

SPOT 1.0 316L



POWER / POWER SUPPLY CODE

max 2W max 500mA
PW1012 ■ ■ ■ A I - ■

LED COLOUR

F - 2700K
5 - 3000K
9 - 4000K
0 - 5000K
1 - blue

OPTICS

S - 10°
M - 20°
L - 40°

POWER CABLES

includes 5 m neoprene cable
 H05RN-F 2x0.35/0.75 Ø6.3 mm
2 - 10 m
3 - 15 m
4 - 20 m

LUMEN OUTPUT AT SOURCE 145 lm (3000K, 500mA)

DELIVERED LUMEN OUTPUT 88 lm (3000K, 500mA, 20°)

NO. AND TYPE OF LED 1 power LED
 1/4 ANSI BIN (white LED colour)
 50000h L90 B10 (Ta 25°C)

MATERIAL body and trim in AISI 316L stainless steel
 screen in transparent, tempered glass

POWER SUPPLY UNIT not included, see p. 904

WIRING series

MOUNTING surface mounted (ceiling, wall, ground, spike)
 max depth 10 m

ACCESSORIES see p. 759

NOTES also suitable for use out of water
 version with elliptical optics available on request

PHOTOMETRIC DATA see p. 883

SPOT 1.6 316L



2W 24Vdc
PW1600 ■ ■ ■ I - ■

F - 2700K
5 - 3000K
9 - 4000K
0 - 5000K
1 - blue

S - 10°
M - 20°
L - 40°

includes 5 m neoprene cable
 H05RN-F 2x0.35/0.75 Ø6.3 mm
2 - 10 m
3 - 15 m
4 - 20 m

145 lm (3000K)

88 lm (3000K, 20°)

1 power LED
 1/4 ANSI BIN (white LED colour)
 50000h L90 B10 (Ta 25°C)

body and trim in AISI 316L stainless steel
 screen in transparent, tempered glass

not included, see p. 904

parallel

surface mounted (ceiling, wall, ground, spike)
 max depth 10 m

see p. 759

also suitable for use out of water
 version with elliptical optics available on request

see p. 883

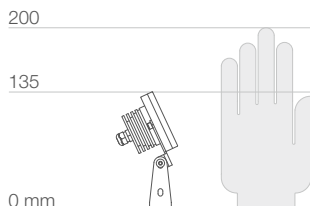
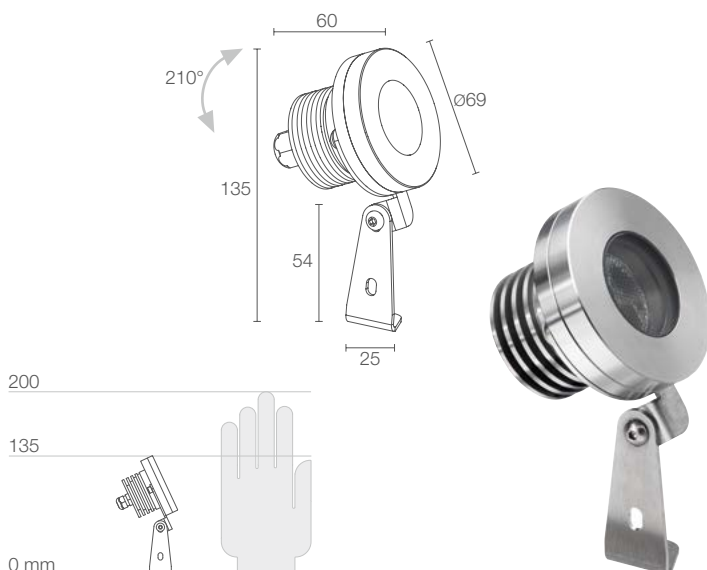

SPOT 2.0 316L



| | |
|----------------------------------|---|
| POWER / POWER SUPPLY CODE | max 6W max 500mA PW2032 ■ ■ ■ A I - ■ |
| LED COLOUR | F - 2700K 5 - 3000K 9 - 4000K 0 - 5000K 1 - blue 6 - RGB |
| OPTICS | S - 10° M - 24° L - 38° |
| POWER CABLES | includes 5 m neoprene cable H05RN-F 2x0.75/0.75 Ø6.3 mm RGB: includes 5 m FEP+RUB cable (equivalent to H05RN-F) 6x0.50/0.50 Ø6.3 mm 2 - 10 m 3 - 15 m 4 - 20 m |

| | |
|------------------------|---|
| LUMEN OUTPUT AT SOURCE | 436 lm (3000K, 500mA) RGB: 277 lm, R: 102 lm G: 132 lm B: 43 lm (500mA) |
| DELIVERED LUMEN OUTPUT | 314 lm (3000K, 500mA, 24°) RGB: 198 lm, R: 73 lm G: 94 lm B: 31 lm (500mA, 24°) |
| NO. AND TYPE OF LED | 3 power LEDs 1/4 ANSI BIN (white LED colour) 50000h L90 B10 (Ta 25°C) |
| MATERIAL | body and trim in AISI 316L stainless steel screen in transparent, tempered extra-clear glass |
| POWER SUPPLY UNIT | not included, see p. 904 and 917 |
| WIRING | series |
| MOUNTING | surface mounted (ceiling, wall, ground, spike) max depth 10 m |
| ACCESSORIES | see p. 759 |
| NOTES | also suitable for use out of water version with elliptical optics available on request |
| PHOTOMETRIC DATA | see p. 883 |

SPOT 2.6 316L



| | |
|----------------------------------|---|
| POWER / POWER SUPPLY CODE | 6W 24Vdc PW2600 ■ ■ ■ I - ■ |
| LED COLOUR | F - 2700K 5 - 3000K 9 - 4000K 0 - 5000K 1 - blue |
| OPTICS | S - 10° M - 24° L - 38° |
| POWER CABLES | includes 5 m neoprene cable H05RN-F 2x0.75/0.75 Ø6.3 mm 2 - 10 m 3 - 15 m 4 - 20 m |

| | |
|------------------------|---|
| LUMEN OUTPUT AT SOURCE | 436 lm (3000K) |
| DELIVERED LUMEN OUTPUT | 314 lm (3000K, 24°) |
| NO. AND TYPE OF LED | 3 power LEDs 1/4 ANSI BIN (white LED colour) 50000h L90 B10 (Ta 25°C) |
| MATERIAL | body and trim in AISI 316L stainless steel screen in transparent, tempered extra-clear glass |
| POWER SUPPLY UNIT | not included, see p. 904 |
| WIRING | parallel |
| MOUNTING | surface mounted (ceiling, wall, ground, spike) max depth 10 m |
| ACCESSORIES | see p. 759 |
| NOTES | also suitable for use out of water version with elliptical optics available on request |
| PHOTOMETRIC DATA | see p. 883 |



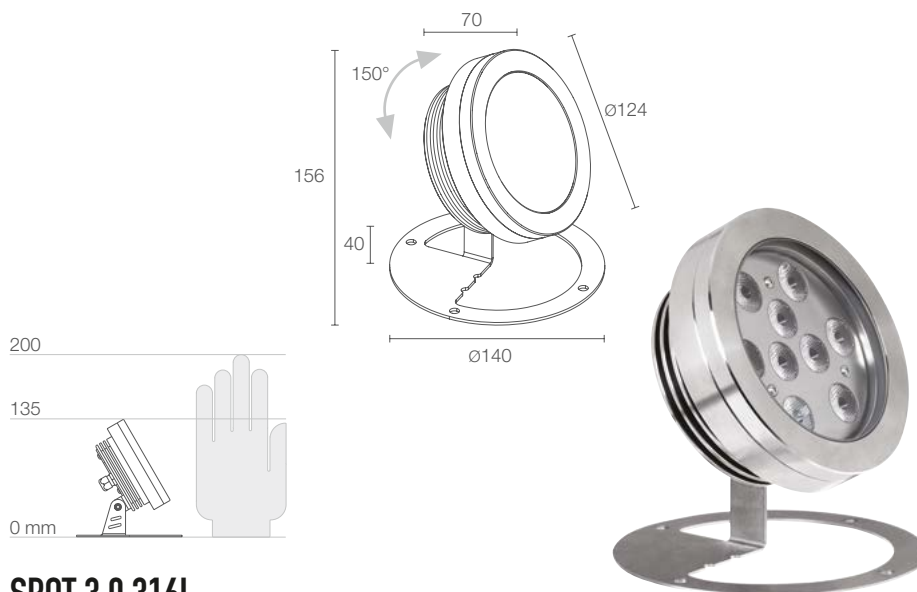

SPOT 3.0 316L



POWER / POWER SUPPLY CODE

12W 24Vdc blue/white light
PW3062 ■ ■ ■ A I - ■

18W 24Vdc blue/white light
PW3092 ■ ■ ■ A I - ■

max 18W max 500mA RGB light
PW3092 6 ■ ■ A I - ■

| | |
|-----------------------|---|
| ■ LED COLOUR | F - 2700K 5 - 3000K 9 - 4000K 0 - 5000K 1 - blue |
| ■ OPTICS | S - 10° M - 20° L - 40° |
| ■ POWER CABLES | includes 5 m neoprene cable H05RN-F 2x0.75/0.75 Ø6.3 mm RGB: includes 5 m FEP+RUB cable (equivalent to H05RN-F) 6x0.50/0.50 Ø6.3 mm 2 - 10 m 3 - 15 m 4 - 20 m |

| | |
|------------------------|--|
| LUMEN OUTPUT AT SOURCE | 872 lm (3000K, 12W) 1308 lm (3000K, 18W) RGB: 791 lm, R: 291 lm G: 375 lm B: 125 lm (500mA) |
| DELIVERED LUMEN OUTPUT | 596 lm (3000K, 20°, 12W) 893 lm (3000K, 20°, 18W) RGB: 565 lm, R: 208 lm G: 268 lm B: 89 lm (500mA, 20°) |
| NO. AND TYPE OF LED | 6, 9 power LEDs, 1/4 ANSI BIN (white LED colour) RGB: 9 power LEDs 50000h L90 B10 (Ta 25°C) |
| MATERIAL | body and trim in AISI 316L stainless steel screen in transparent, tempered extra-clear glass |
| POWER SUPPLY UNIT | not included, see p. 904 and 917 |
| WIRING | parallel RGB: series |
| MOUNTING | surface mounted (ceiling, wall, ground) max depth 10 m |
| ACCESSORIES | see p. 759 |
| NOTES | also suitable for use out of water version with elliptical optics available on request |
| PHOTOMETRIC DATA | see p. 883 |

< SPOT 3.0 316L
RGB, 18W

Light planning by / Garofoli
Bari Palese airport, Bari, Italy





ACCESSORIES

ACCESSORIES FOR INSTALLATION



WP0100

Spike for in-ground installation
(Spot 1.0 316L / 1.6 316L /
2.0 316L / 2.6 316L)

UNDERWATER AND OUTDOOR PROJECTORS

SPOT 1.0 316L 1.6 316L

S - 10°

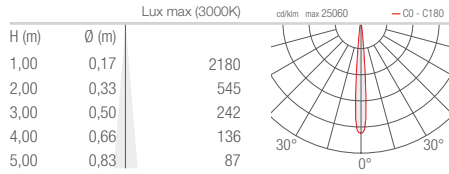

M - 20°

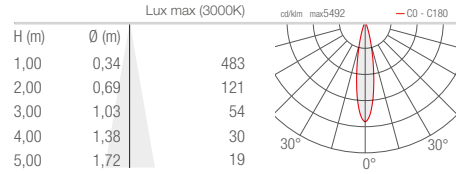

L - 40°

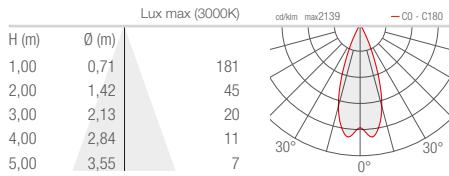

SPOT 2.0 316L 2.6 316L

S - 10°

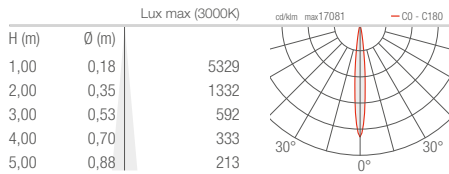

M - 24°

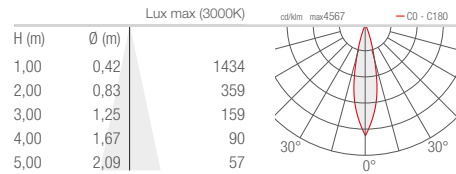

L - 38°

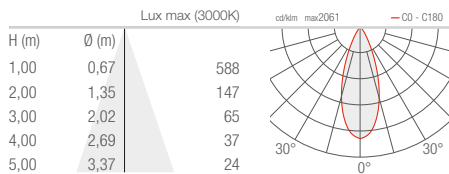

SPOT 3.0 316L

S - 10°

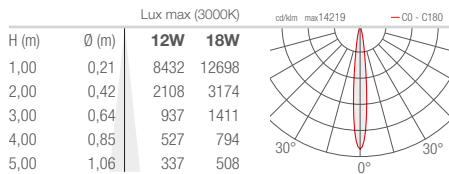

M - 20°

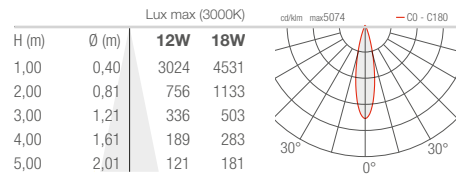

L - 40°

