



Technical Specs

ECPNL2301DM20 Touch Panel

Input Voltage:	115-230 Vac 50/60 Hz
Output Signal:	RF 2.4GHz,
Control Mode:	DMX512 RGBW, 4 Zones Control
Working Temp.:	-30°C~ 55°C
Size:	L86×W86×H36 (mm)
Weight(G.W.):	225 g

TOUCH PANEL (RGBW)

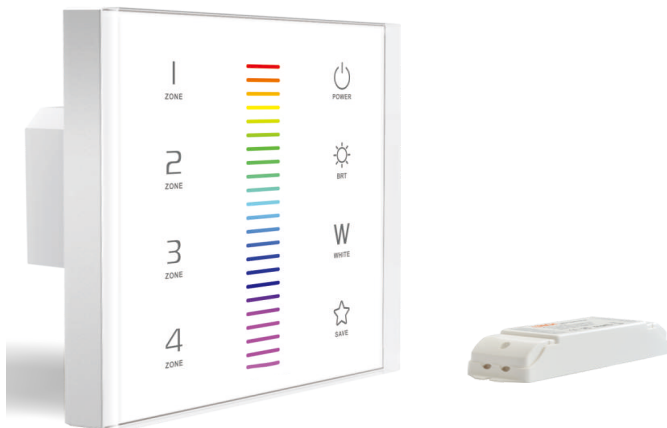

Product Size:

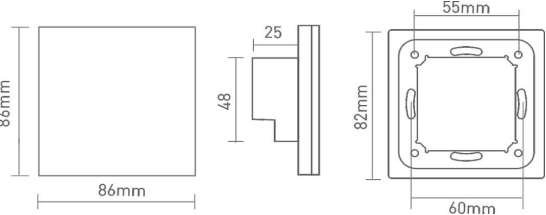

Terminals

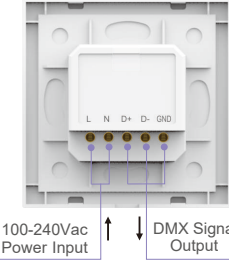

Installation Instruction:

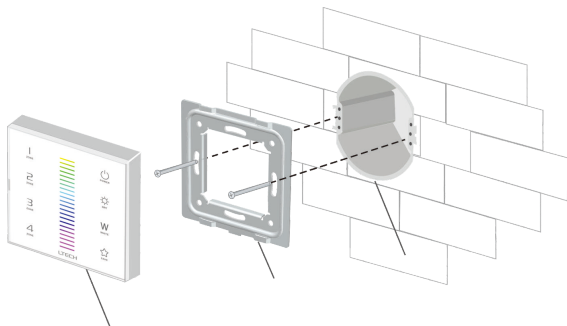

1. Install the back box into the wall. Typical boxes as below:

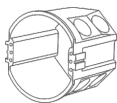

European style

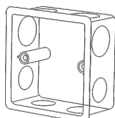

86 size

2. screw the baseplate and the back box in the wall firmly.

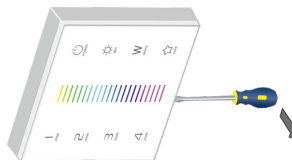

3. Connect in a right way and put the panel into the back box.

4. Use a straight screwdriver to pry the position shown:

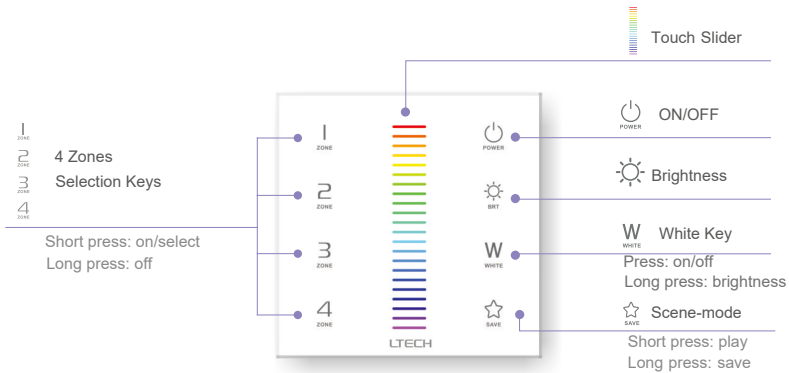

Key Functions



- * When the touch panel is off, Long press to  turn on/off the buzzer
- When the touch panel is on, Long press  to match code.

Wireless System Wiring

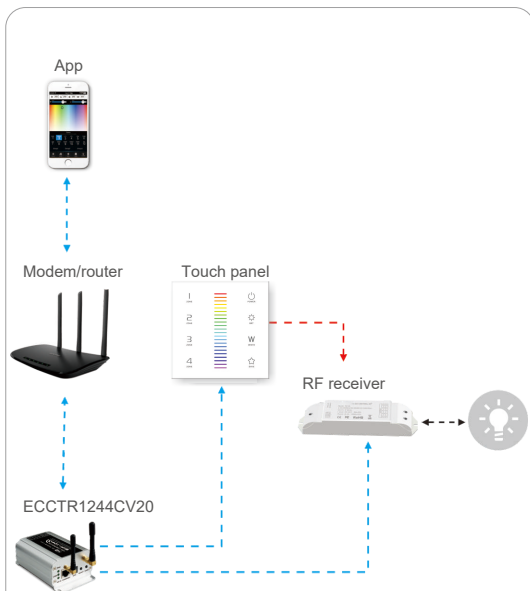

*PS: No WiFi router needed when ECCTR1244CV20 work with phones directly.

Match Code Sequence

1. ECCTR1244CV20 & ECPNL2301DM20
2. ECPNL2301DM20 & RF receiver

Match / Clear Code for Touch panel & ECCTR1244CV20

Match Code:

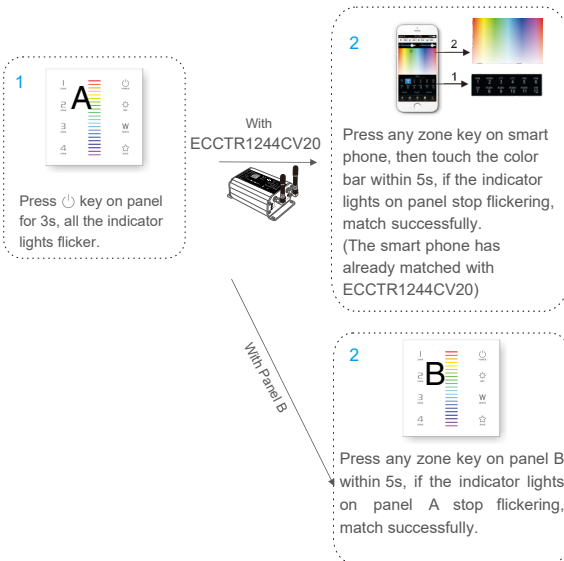

Clear Code:



Application Composition

Wireless Control options:

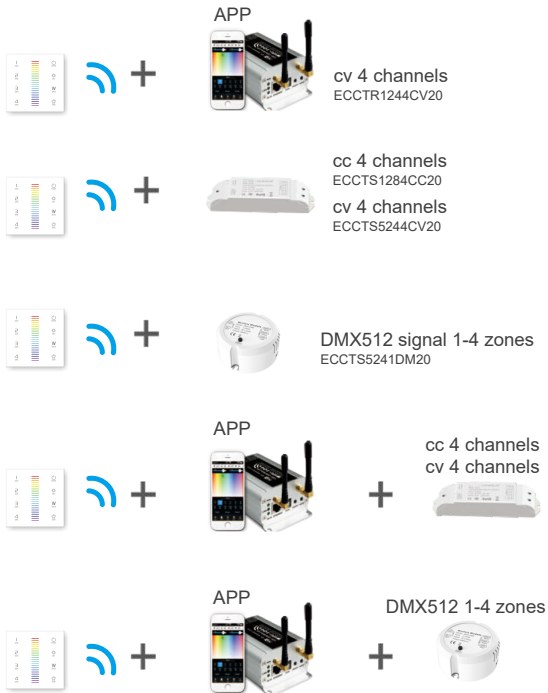

DMX Output Wiring

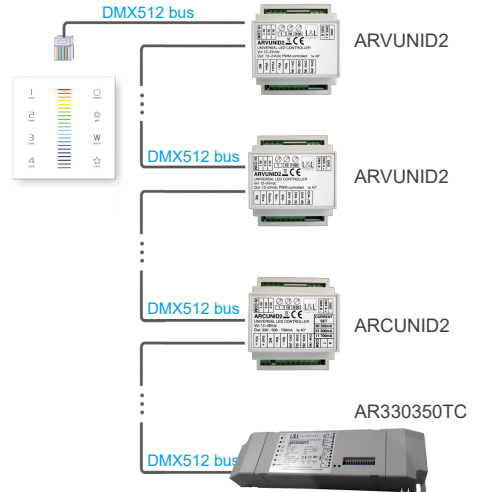

RF Wireless Wiring

Match/Clear Code between Touch Panel & Receiver

Match code:

Method 1 : When the touch panel is on and the wiring between the receiver and the lamps are correct.

1.



Power on the receiver, and complete step 2 within 10s.

2.

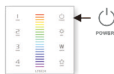

Long press  on the touch panel, the lamps flicker.

3.

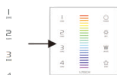

Touch the matching zone key on the touch panel, the lamps stop flickering, match successfully.

Method 2 : When the touch panel is on and the wiring between the receiver and the lamps are correct.

1.



Short press "ID learning button" on the receiver.

2.



Long press  on the touch panel, the lamps flicker.

3.

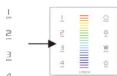

Touch the matching zone key on the touch panel, the lamps stop flickering, match successfully.

Clear code:

Method 1: Power on and off the receiver continuously for 5 times, if the buzzer long beep and lamps flicker twice, deactivate the matching successfully.



Method 2: Long press "ID learning button" on receiver for 5 seconds, if the lamps flicker twice, deactivate the matching successfully.

